

APPLICATIONS

Food prep case featuring:

- Refrigerated display and prep counter plus refrigerated rear storage
- Fold down sneeze guard
- Work surface features removable, USDA grade, polycarbonate cutting boards.

STANDARD FEATURES

CABINET/CANOPY CONSTRUCTION

- Refrigerated storage under cabinet with lighted shelving.
- Stainless steel prep counter includes 2 reversible USDA grade, polycarbonate cutting boards cutting boards, 2 trash chutes with removable 1/3 size pans and recessed shelf space.
- Front, end panels, and all edges consist of 3/4" plywood panels finished in high pressure plastic laminate.
- Front glass on hydraulic lift system serves as pan cover and front sneeze guard.
- Stainless steel canopy features glass end panels and LED lighting with shatter shield and separate on/off switch.
- Hinged front panel allows easy access for cleaning and servicing electrical and plumbing components.
- Cold prep area accommodates 18 1/4 size pans (Pans sold separate).

REFRIGERATION SYSTEM

- Integrated self-contained refrigeration with blower coil system wired to standard refrigeration controls accommodate rear and countertop areas.
- Digital readout thermometer provided to verify cabinet temperature is maintained between 38° and 40°F.
- Condensate drains to floor drain.
- Rear refrigerated storage has a blower coil with NSF certified coating, wire shelving, clear insulated sliding doors, incandescent lights and thermometer.

ELECTRICAL REQUIREMENTS

- Unit is pre-wired and furnished with a junction box for use on a dedicated 120V, 60Hz, 1 phase circuit.

WARRANTY

- One year - Parts and Labor

The Fold-Down Sneeze Guard doubles as an insulated food pan cover allowing product to be stored in the cold pans at night.

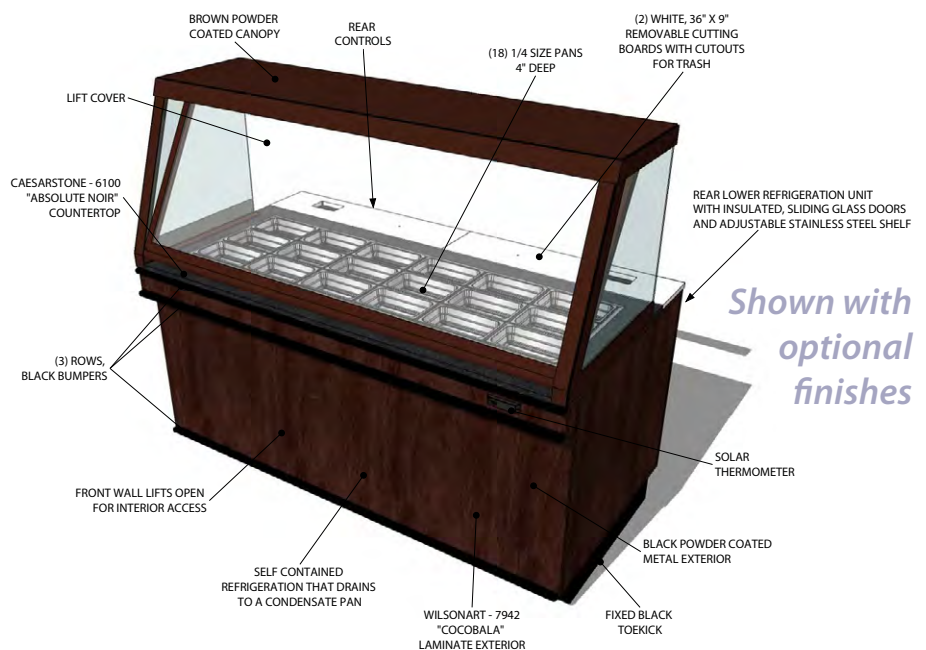

Shown with optional finishes

Engineered for stores with ambient conditions not to exceed 75°F and 55% relative humidity. Due to continuous improvements specifications may change without notice.

OPTIONS

- Powder coated interior and sneeze guard.
- Countertop to be laminate, solid surface or quartz engineered stone.
- Assorted colors available for countertop, laminate, vinyl bumper and powder coat.
- Bar packages can provide inset pans, lids, tongs, ladles, serving spoons and salad dressing templates.
- Wire or glass shelves in lieu of sheet metal.
- Mirror interior end panels.
- Solid or mirrored sliding doors available for rear refrigerated storage.
- End panels available in solid wood or glass.
- Available for glycol systems.
- Cord set available in lieu of junction box.

Built to meet the following specifications:



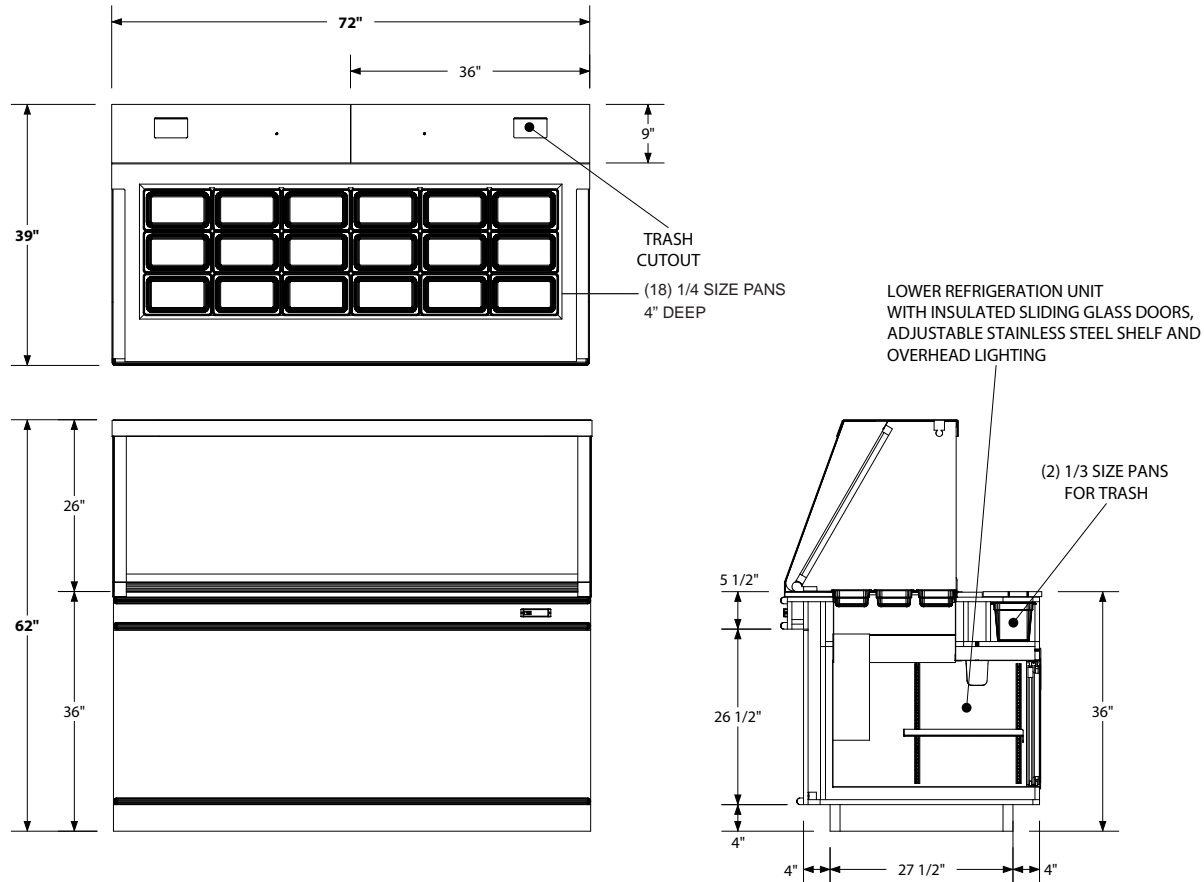

Unit Length	# of 1/4 Size Pans	Dimensions (inches)		
		W	D	H
6'	18	72	39	62

Additional Sizes Available

ELECTRICAL/REFRIGERATION SPECIFICATIONS

ELECTRICAL REQUIREMENTS

QTY	DESCRIPTION	MANUFACTURER	MODEL #	VOLTAGE	AMPS EA	AMPS TOTAL
1	5' LED LIGHT	ELECTALED	EFDS-5-35-06-NM	120	.23	.23
1	L20 LIGHT	CHG	L20-1010	120	.33	.33
1	COIL	BOHN	BBM-16	120	1.6	1.6
1	CONDENSING UNIT	TECUMSEH	AEA9422ZXAXC	120	8.8	8.8
TOTAL ELECTRICAL REQUIRED IS 120V, 60 Hz, 1 PH						10.96

REFRIGERATION SPECIFICATIONS

QTY	DESCRIPTION	MANUFACTURER	MODEL #	BTU'S EACH	EVAP TEMP	REF. TYPE/OZ
1	SC REF. BOX	R&D FIXTURES	N/A	1600	+20°	404-A